

HEAVY DUTY CYLINDRICAL KNOB LOCKSETS

CK4200 SERIES

GLOBAL

- Ideal for high-use commercial, industrial and institutional applications such as schools, universities, hotels, offices and apartments, hospitals and nursing homes, churches, airports, municipal buildings, retail complexes, warehouses
- Patented "Lock-on" rose liners and thimble increase security and prevent lock from loosening
- 1 3/4" knob shank minimizes wear
- Knob: Wrought reinforced
- 5/8" latch and concealed knob catch enhance strength
- Rose: Wrought reinforced

SPECIFICATIONS

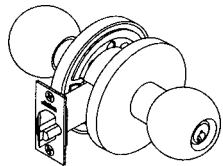

- Door Thickness: 1 3/4" - 2" standard
- Backset: 2 3/4" standard
- Lock Chassis: Steel, zinc dichromated for corrosion resistance
- Auxiliary Latchbolt: Deadlocking latchbolt prevents manipulation when door is closed
- Handing: Field Reversible
- Front: 2 1/4" x 1 1/8" Accommodates doors beveled 1/8" in 2"
- Latchbolt: Brass, chrome plated with 5/8" throw, with nylon insert
- ANSI: Meets A156.2 Series 4000, Grade 1
- Federal: Meets FF-H-106C
- Cylinder: Brass 6-pin, L4 keyway, 0-bitted

Catalog #	Description	Finish	Trim
CL4251 GRC 626	Entrance/Office	Satin Chromium Plated	Wrought 2 7/8"
<i>Pushing turn button in locks outside knob requiring use of key outside to unlock • Inside knob always free • Deadlocking latchbolt by knob either side except when turn button locks outside knob</i>			
CL4255 GRC 626	Classroom	Satin Chromium Plated	Wrought 2 7/8"
<i>Outside knob unlocked by key outside • Inside knob always free • Deadlocking latchbolt by knob either side except when key outside locks outside knob</i>			
CL4257 GRC 626	Storeroom/Closet	Satin Chromium Plated	Wrought 2 7/8"
<i>Outside knob always rigid • Inside knob always free • Deadlocking latchbolt by key in outside knob or by rotating inside knob</i>			

HEAVY DUTY CYLINDRICAL LEVER LOCKSETS

CL3300 SERIES

NEWPORT

- Ideal for high-use commercial, industrial and institutional applications such as schools, universities, hotels, offices and apartments, hospitals and nursing homes, churches, airports, municipal buildings, retail complexes, warehouses
- Patented Lever Release design for vandal resistance
- Anti-rotation throughbolts
- UL 3-hour fire rating for 4' x 10' door
- Lever: Die Cast zinc
- Solid cast levers
- Independent return springs prevent lever sag
- Cover ANSI/DHI Door Prep A115.18-1994 "Spider Cut Out"
- Rose: Wrought brass or bronze

SPECIFICATIONS

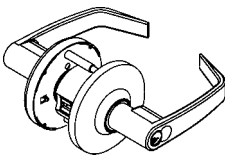

- Door Thickness: 1 3/4" - 2" standard
- Backset: 2 3/4" standard
- Lock Chassis: Steel, zinc dichromated for corrosion resistance
- Auxiliary Latchbolt: Deadlocking latchbolt prevents manipulation when door is closed
- Handing: Non-Handed
- Front: 2 1/4" x 1 1/8" Accommodates flat doors and doors beveled 1/8" in 2"
- Latchbolt: Brass, chrome plated with 1/2" throw,
- ANSI: Meets A156.2 Series 4000, Grade 1 Meets A117.1 Accessibility Code
- Federal: Meets FF-H-106C
- Cylinder: Brass 6-pin, L4 keyway, 0-bitted

Catalog #	Description	Finish	Trim
CL3310 NZD 626	Passage/Closet	Satin Chromium Plated	3 1/2"
<i>Both levers always free • Latchbolt by lever either side</i>			
CL3320 NZD 626	Privacy/Bedroom/Bathroom ...	Satin Chromium Plated	Wrought 2 7/8"
<i>Outside lever locked by push button (Outside lever handle is free wheeling in locked position) • Inside lever always free • Throw-off latchbolt by lever closing door or by turning inside lever</i>			
CL3351 NZD 626	Entrance/Office	Satin Chromium Plated	Wrought 2 7/8"
<i>Pushing turn button in locks outside lever requiring use of key outside to unlock (Outside lever handle is free wheeling in locked position) • Inside lever always free • Deadlocking latchbolt by lever either side except when turn button locks outside lever</i>			



Smallwood Lock Supply

1830 Minnesota Avenue • Kansas City, KS 66102

Local

www.smallwoodlock.com

Toll-Free

913-371-5787

Fax: 913-371-3201



888-881-4245

Fax: 888-881-4248

CL3300 Continued...

- Prepared for Corbin IC core cylinder
- 6-pin cylinder less core

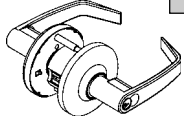

Catalog #	Description	Finish	Trim
CL3351 CL6 NZD 626	Entrance/Office	Satin Chromium Plated	Wrought 2 7/8"
<i>Inside lever always free • Deadlocking latchbolt by lever either side except when turn button locks outside lever • Pushing turn button in locks outside lever requiring use of key outside to unlock (Outside lever handle is free wheeling in locked position)</i>			
CL3355 CL6 NZD 626	Classroom	Satin Chromium Plated	Wrought 2 7/8"
<i>Inside lever always free • Deadlocking latchbolt by lever either side except when key outside locks outside lever (Outside lever handle is free wheeling in locked position) • Outside lever unlocked by key outside</i>			
CL3357 CL6 NZD 626	Storeroom/Closet	Satin Chromium Plated	Wrought 2 7/8"
<i>Inside lever always free • Deadlocking latchbolt by key in outside lever or by rotating inside lever (Outside lever handle is free wheeling in locked position)</i>			

PUSHPAD EXIT DEVICES

- Ideal for schools and universities, health care, government and public, commercial and industrial, office and retail, transportation and utilities, hotels, conference centers, religious centers
- Heavy duty steel construction
- 3/4" latchbolt standard on rim device
- No projecting parts to inhibit egress
- Easy-to-use for quick egress and ADA compliance
- Low profile & projection for barrier-free code compliance
- Accommodates various trim functions

ED8200

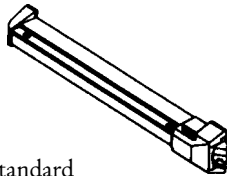

SPECIFICATIONS

- ✍ Door Thickness: 1 1/4" standard
- ✍ Backset: 2 3/4" standard
- ✍ Stile: Minimum width 5"
- ✍ Dogging: Single point, 1/4 turn standard
- ✍ Projection: 2 1/2"
- ✍ Bar Length: 36" bar fits 31"-36" door; easily field cut to size
- ✍ Latchbolt: 3/4" stainless steel pullman type with stainless steel deadlocking latch
- ✍ Handing: Non-Handed
- ✍ WHI: Listed as fire exit hardware for installation on up to 1 1/2" hour fire doors, up to 8' x 8'
- ✍ ANSI: Meets A156.3, Type 1, Grade 1
Meets A117.1 Accessibility Code
- ✍ UL/cUL: Listed by Underwriters Laboratories Inc., as fire exit hardware
- ✍ Approved by California State Fire Marshal

ED8400

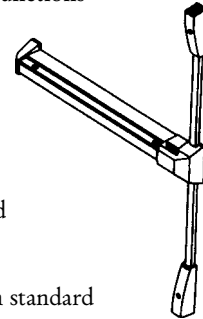

SPECIFICATIONS

- ✍ Door Thickness: 1 1/4" standard
- ✍ Backset: 2 3/4" standard
- ✍ Stile: Minimum width 5"
- ✍ Dogging: Single point, 1/4 turn standard
- ✍ Projection: 2 1/2"
- ✍ Bar Length: 36" bar fits 31"-36" door; easily field cut to size
- ✍ Latchbolt Top: 1/2" interlocking drop latch
Bottom: 5/8" pivoted
- ✍ Vertical Rod: Inverted U-shaped rectangular
- ✍ Handing: **Specify Handing**
- ✍ WHI: Listed as fire exit hardware for installation on up to 1 1/2" hour fire doors, up to 8' x 8'
- ✍ ANSI: Meets A156.3, Type 1, Grade 1
Meets A117.1 Accessibility Code
- ✍ UL/cUL: Listed by Underwriters Laboratories Inc., as fire exit hardware
- ✍ Approved by California State Fire Marshal

Catalog #	Description	Handed	Finish
ED8200 M54 689	Rim Mounted		Silver Aluminum Painted
ED8200 M54 690	Rim Mounted		Dark Bronze Painted
ED8400 LHR M54 689	Rim Mounted, Vertical Rod	Left Hand	Silver Aluminum Painted
ED8400 RHR M54 689	Rim Mounted, Vertical Rod	Right Hand	Silver Aluminum Painted

Smallwood Lock Supply

1830 Minnesota Avenue • Kansas City, KS 66102

Local

913-371-5787
Fax: 913-371-3201

www.smallwoodlock.com

COR 2

Toll-Free

888-881-4245
Fax: 888-881-4248

..... ACCESSORIES FOR ED8200, ED8400

N655

- Newport Lever
- Rose: Wrought brass or bronze
- Die cast zinc
- Cylinder: Key-in-lever



Catalog #	Description	Finish	Trim
N655 626 LC	Classroom Lever	Satin Chromium Plated	3½"

G1055

- Global Knob
- Rose: Wrought brass or bronze
- Wrought
- Less cylinders

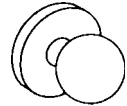

Catalog #	Description	Finish	Trim
G1055 613 LC	Classroom Knob	Dark Oxidized Satin Bronze	3½"
G1055 626DLC	Classroom Knob	Satin Chromium Plated	3½"

F157

- Plate: Steel
- Cylinder: Rim

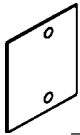

Catalog #	Description	Finish	Trim
F157 689	Flat Plate	Silver Aluminum Painted	3½" x 4"
F157 690	Flat Plate	Dark Bronze Painted	3½" x 4"

**P850
P857**

- Pull: Extruded
- Cylinder: Rim

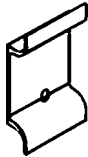

Catalog #	Description	Finish	Trim
P850 689	Wing Pull Dummy	Silver Aluminum Painted	3½" x 6" x 1½"
P850 690	Wing Pull Dummy	Dark Bronze Painted	3½" x 6" x 1½"
P857 689	Wing Pull Nightlatch	Silver Aluminum Painted	3½" x 6" x 1½"
P857 690	Wing Pull Nightlatch	Dark Bronze Painted	3½" x 6" x 1½"

We stock a full line of original Corbin/Russwin key blanks to meet your needs!

NOTES

Smallwood Lock Supply

1830 Minnesota Avenue • Kansas City, KS 66102

Local

www.smallwoodlock.com

Toll-Free

913-371-5787

Fax: 913-371-3201

COR 3

888-881-4245

Fax: 888-881-4248



DOOR CLOSERS

DC4603

- Ideal for residences, offices, apartments, hotels and motels, retail outlets, warehouses
- Universal mounting
- Valves adjust closing and latching speeds
- Allows full 180° door opening
- Low projection - just 2 7/8"

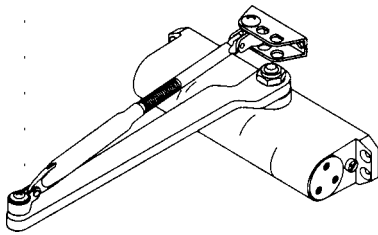

**Regular
Arm Mounting**

**Parallel
Arm Mounting**

**Top Jamb
Mounting**

SPECIFICATIONS

- ✍ Handing: Non-Handed
- ✍ Body: Cast aluminum
- ✍ Arm: Steel main arm
- ✍ Frame: Tubular steel turnbuckle
- ✍ Spindle: Precision machine steel
- ✍ Fluid: High lubricity hydraulic fluid
- ✍ Piston: Precision machine steel
- ✍ 15% (± 7-1/2%) power adjustment arm bracket
- ✍ Valves: One for closing speed, and one for backcheck arms to U.L. Standard 10C
- ✍ Mounting: Regular top jamb
- ✍ ANSI/BHMA: 156.4 Grades

Catalog #	Size of Door
DC4603 M54 M100 689	3'
Comes With Sex Nuts & Bolts • Silver Aluminum Painted <i>Tri-package (regular, top jamb and parallel arm)</i>	
DC4603 M54 M100 690	3'
Comes With Sex Nuts & Bolts • Dark Bronze Painted <i>Tri-package (regular, top jamb and parallel arm)</i>	
DC4604 M54 M100 689	4'
Comes With Sex Nuts & Bolts • Silver Aluminum Painted <i>Tri-package (regular, top jamb and parallel arm)</i>	
DC4604 M54 M100 690	4'
Comes With Sex Nuts & Bolts • Dark Bronze Painted <i>Tri-package (regular, top jamb and parallel arm)</i>	

DC2210

- Ideal for schools and universities, health care, government and public, commercial and industrial, office and retail, transportation and utilities, hotels and conference centers, religious
- Unique pressure-relief backcheck intensity valve includes safety feature to maintain correct internal pressure
- Innovative multiple backcheck location valve offers 70° or 90° backcheck setting on all mountings
- One-piece seamless steel spring tube seals in hydraulic fluid
- 15% power adjustment arm bracket
- Tapered valves allow precise adjustment
- QUIK-INSTALL™ mounting brackets
- Up to full 180° door opening
- Compliance with building and barrier-free codes

**Regular
Arm Mounting**

**Parallel
Arm Mounting**

**Top Jamb
Mounting**

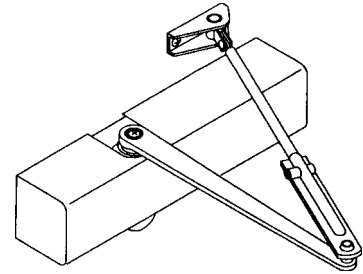

SPECIFICATIONS

- ✍ Handing: Non-Handed
- ✍ Body: Cast iron case with seamless one-piece forged
- ✍ Arm: Heavy duty forged steel spring tube
- ✍ Spindle: Triple heat treated steel
- ✍ ANSI: Meets A156.4, Grade 1
- ✍ Piston: Precision heat treated steel, tempered Meets A117.1 Accessibility Code
- ✍ Federal: Meets FF-H-121D, Type 3000
- ✍ UL/ULC: Listed for fire and cycle requirements

Catalog #	
DC2210 M54 689	
Comes With Sex Nuts & Bolts Silver Aluminum Painted	

NOTES

Smallwood Lock Supply

1830 Minnesota Avenue • Kansas City, KS 66102

Local

www.smallwoodlock.com

Toll-Free

913-371-5787
Fax: 913-371-3201

COR 4

888-881-4245
Fax: 888-881-4248